

145x210mm

Passage & Privacy Set Fitting Instructions

1. Using the template below, draw drilling centres into the door.
2. Drill holes A to F as indicated in Figure 1 and Figure 2 and the latch.
3. Insert spindle and rubber ring in groove as shown.
4. Insert and tighten two tie bolt screws to secure the levers.
5. Insert privacy pin on inside rose.
6. There is no warranty cover for incorrect installation.

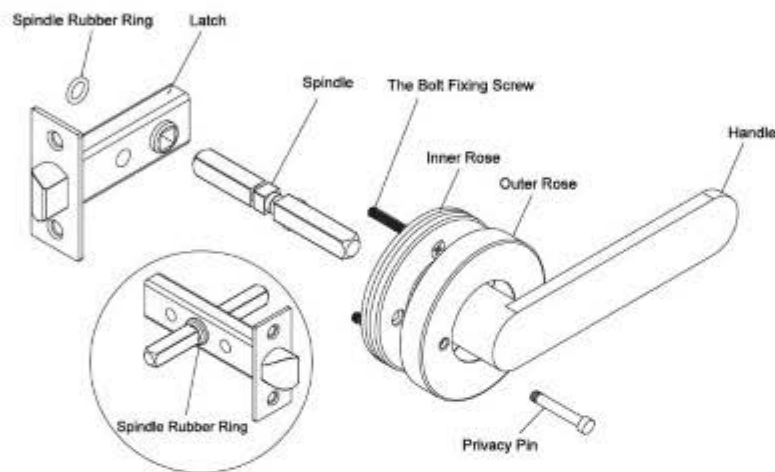

FIGURE 1

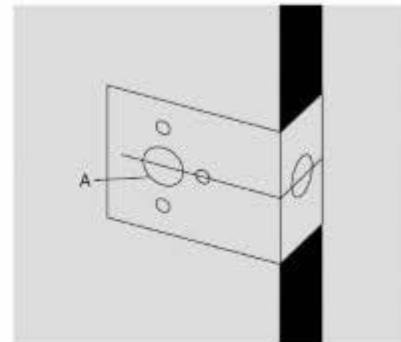
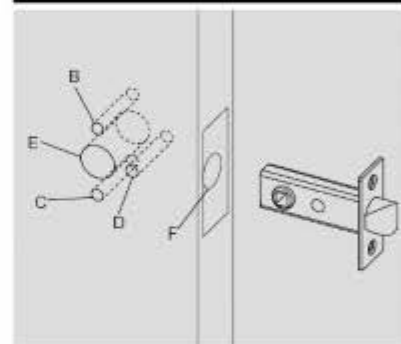

FIGURE 2



PASSAGE/PRIVACY SET INSTALLATION

important - Double check dimensions if printing from an electronic version

